



Investment - Let

59A HIGH STREET, GRAVESEND, DA11 0BB

Per Month

£3,600

FEATURES

- Six spacious double bedrooms
- Fully compliant HMO – ideal for company let
- Prime High Street location in Gravesend
- Modern communal kitchen with ample storage and appliances



BEXLEY HOMES

6 Bedroom Investment – Let located in Gravesend

6-Bedroom HMO – Ideal for Company Let

A well-presented and spacious six-bedroom HMO property, ideally suited for a company let agreement, located in the heart of Gravesend town centre.

The property offers six generously sized double bedrooms, making it ideal for professional occupants or corporate accommodation. There is a modern communal kitchen, fully equipped to accommodate multiple tenants, alongside two high-specification shower rooms and an additional separate W/C, ensuring convenience and comfort for all residents.

Location & Connectivity

Positioned on the High Street, the property benefits from immediate access to a wide range of local amenities including shops, supermarkets, cafés, and

Call us on
01322 948500

Belvedere@bexleyhomes.co.uk
www.bexleyhomes.co.uk

Council Tax Band

A

Approx Gross Internal Area
133 sq m / 1432 sq ft

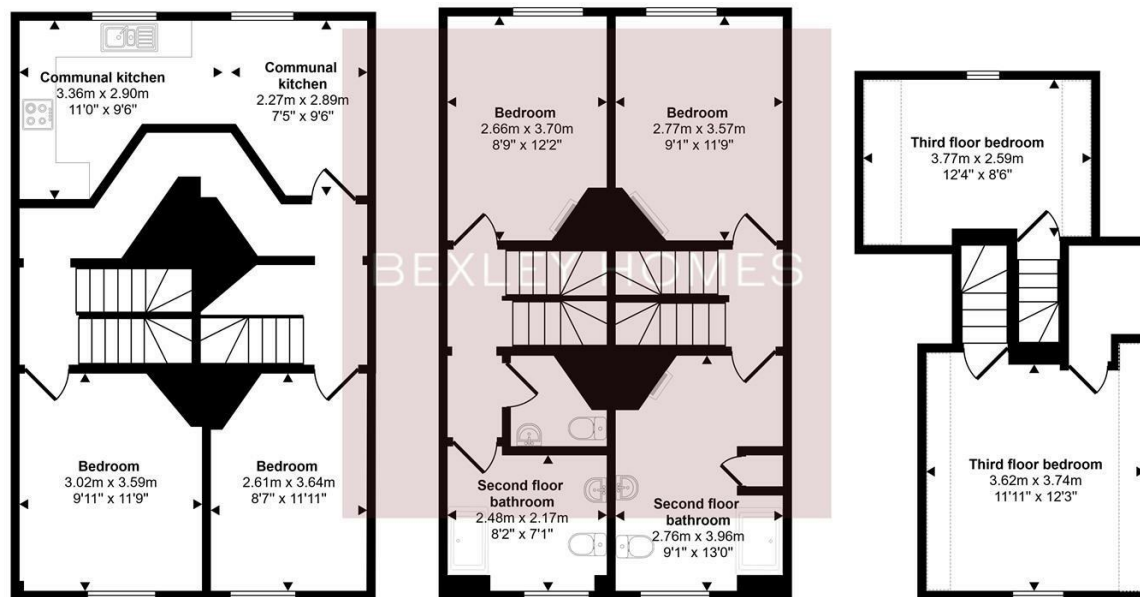

First floor
Approx 54 sq m / 584 sq ft

Second floor
Approx 52 sq m / 557 sq ft

Third floor
Approx 27 sq m / 290 sq ft

Denotes head height below 1.5m

This floorplan is only for illustrative purposes and is not to scale. Measurements of rooms, doors, windows, and any items are approximate and no responsibility is taken for any error, omission or mis-statement. Icons of items such as bathroom suites are representations only and may not look like the real items. Made with Made Snappy 360.

| Energy Efficiency Rating | | Current | Potential |
|---|---|-------------------------|-----------|
| Very energy efficient - lower running costs | | | |
| (92 plus) | A | | |
| (81-91) | B | | |
| (69-80) | C | | |
| (55-68) | D | 63 | |
| (39-54) | E | | |
| (21-38) | F | | |
| (1-20) | G | | |
| Not energy efficient - higher running costs | | | |
| England & Wales | | EU Directive 2002/91/EC | |

Agents Note: Whilst every care has been taken to prepare these particulars, they are for guidance purposes only. All measurements are approximate and are for general guidance purposes only and whilst every care has been taken to ensure their accuracy, they should not be relied upon and potential buyers are advised to recheck the measurements.

BEXLEY HOMES